

**DL701, DL704 and DL707**  
**Seven Segment Displays**

**FEATURES**

- Easy to read 0.3" character
- Low cost, light pipe construction
- I.C. power supply compatible
- Standard 14 pin D.I.L. package
- Common anode or common cathode available

**DIMENSIONS**

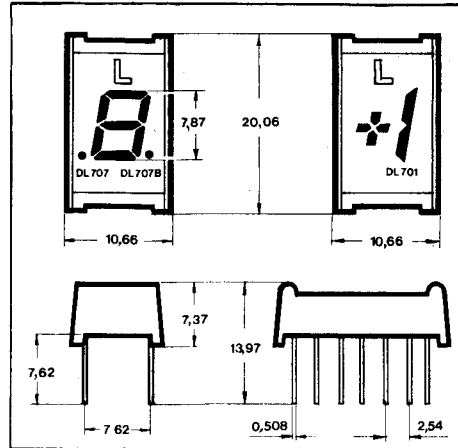

**MAXIMUM RATINGS**

|   |  |
|---|--|
| Power dissipation at $T_A=25^\circ\text{C}$                 | 500mW                                      |
| Continuous forward current. Total<br>Per segment or decimal | 240mA<br>30mA                              |
| Peak Inverse voltage per segment<br>or decimal              | 3.0V                                       |
| Operating temperature range                                 | $-20^\circ\text{C}$ to $100^\circ\text{C}$ |

**REFERENCE TABLE**

| Device | Polarity       | Stock No.     |
|--------|----------------|---------------|
| DL701  | Common Anode   | <b>34627A</b> |
| DL704  | Common Cathode | <b>34626C</b> |
| DL707  | Common Anode   | <b>34624G</b> |
| DL707R | Common Anode   | <b>34625E</b> |

**7**

**OPTO-ELECTRONIC CHARACTERISTICS @  $T_A=25^\circ\text{C}$**

| Parameter                      | Min. | Typ. | Max. | Unit          | Test Condition        |
|--------------------------------|------|------|------|---------------|-----------------------|
| Luminous intensity             | 0.4  | 0.7  |      | mcd           | $I_F=10\text{mA}$     |
|                                | 0.9  | 1.4  |      | mcd           | $I_F=20\text{mA}$     |
| Emission peak wavelength       | 630  |      | 700  | nm            |                       |
| Line half width                |      | 40   |      | nm            |                       |
| Forward voltage                |      | 1.7  | 2.0  | V             | $I_F=20\text{mA}$     |
| Forward voltage (DL701 $\pm$ ) |      | 3.4  | 4.0  | V             | $I_F=20\text{mA}$     |
| Dynamic resistance             |      | 6.0  |      | $\Omega$      | $I_F=10\text{mA}$     |
| Capacitance                    |      | 120  |      | pF            | $V=0$ $f=1\text{MHz}$ |
| Reverse leakage                |      | 0.1  | 100  | $\mu\text{A}$ | $V_R=3.0$ V           |

*Continued on next page*

PLEASE QUOTE STOCK NO. AND MANUFACTURER'S CODE WHEN ORDERING

### CONNECTION DIAGRAM

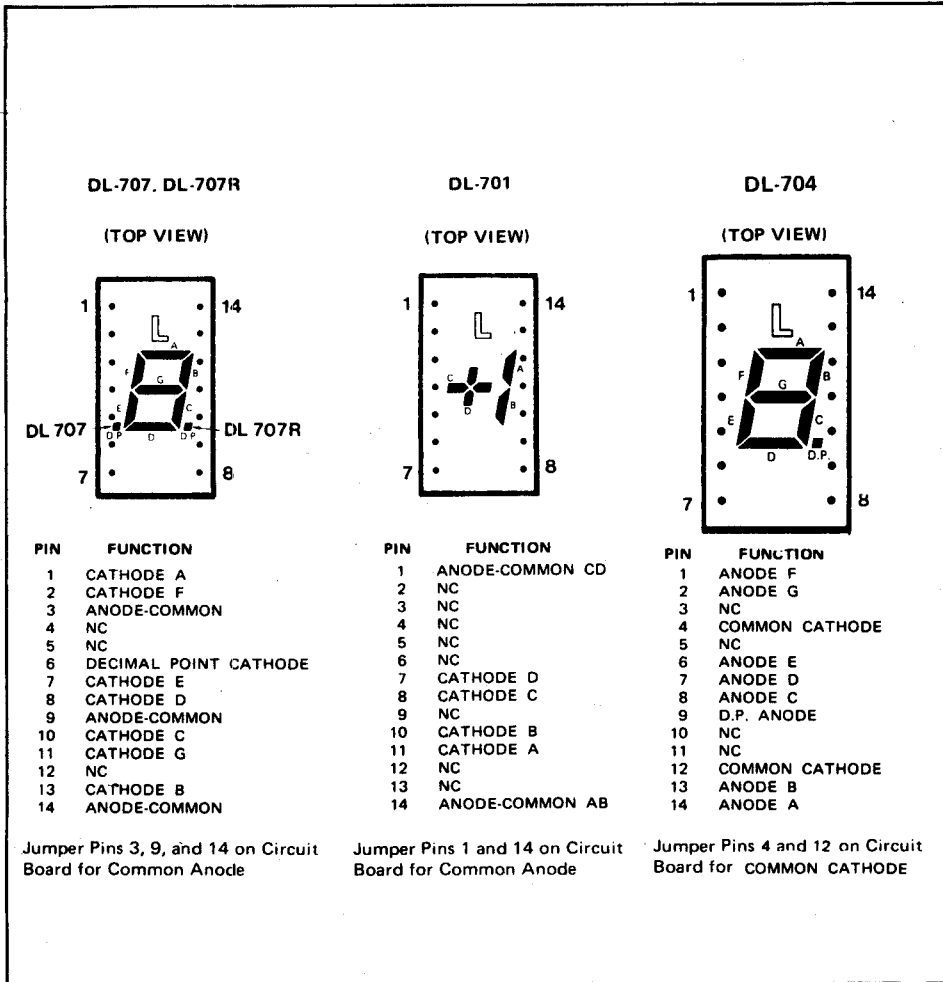

MANUFACTURER'S CURRENT LIST PRICES ARE ALWAYS CHARGED